

Queensbury Place,  
Blackwater, Camberley, GU17 9LX

£1,100 PCM



\*\*\*Available 13th May 2024\*\*\*

A well presented one bedroom end of terrace home located on a quiet walk way on the popular Hawley Hill development in Blackwater, offering easy access to local amenities as well as Camberley town centre.

The accommodation comprises entrance hall, lounge and kitchen on the ground floor whilst the first floor offers double bedroom with fitted wardrobes and bathroom.

Outside there is a garden to the rear and 2 allocated parking spaces.

Unfurnished  
Regret No Pets  
Council Tax Band C: £2078.05pa  
Disclaimer; Council Tax charges change annually



1a Guildford Road, Frimley Green, Camberley, Surrey, GU16 6NL  
Tel: 01252 834949 admin@luff-associates.com www.luff-associates.com

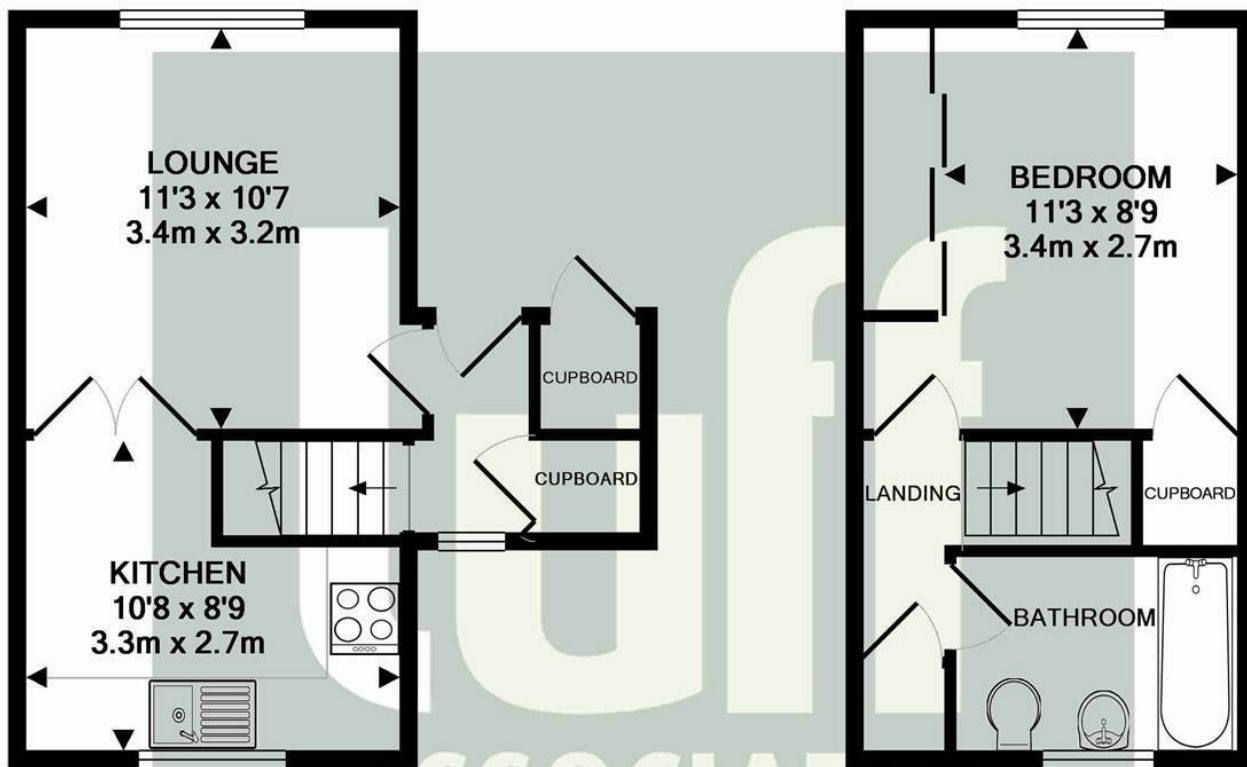

GROUND FLOOR

letting specialists 1ST FLOOR

Whilst every attempt has been made to ensure the accuracy of the floor plan contained here, measurements of doors, windows, rooms and any other items are approximate and no responsibility is taken for any error, omission, or mis-statement. This plan is for illustrative purposes only and should be used as such by any prospective purchaser. The services, systems and appliances shown have not been tested and no guarantee as to their operability or efficiency can be given  
 Made with Metropix ©2014

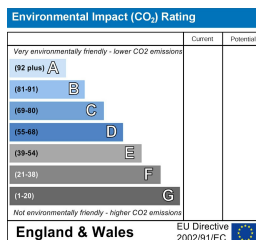
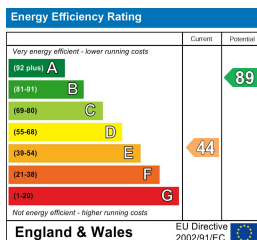

In partnership with  
**LUFF & WILKIN**  
 sales 01252 838 899

Disclaimer: The Rent advertised does not include the Tenancy Deposit or any fee's or charges which are payable. Further information can be obtained from the agent or at the point of viewing. These details have been prepared and issued in good faith and do not constitute representations of fact or form part of any offer or contract Luff Associates Ltd have not carried out a structural survey of the property, nor have we tested any of the services or appliances. All measurements are intended to be approximate only and all photographs show parts of the property as they were at the time they were taken. Any reference to alterations or particular use of the property wherever stated, is not a statement that planning, building regulations or other relevant sent has been obtained